

# ***Firehawk Fire Alarms***

## ***Battery Powered***

***Information, Installation and  
Maintenance***



***FHB10 Smoke Alarm***



***FHH10i Heat Alarm***



*FHB10 / 10i Smoke Alarm*



*FHH10i Heat Alarm*

Sounder



*FHB10 / 10i Smoke Alarm*



*FHH10i Heat Alarm*

Red LED



*FHB10 / 10i Smoke Alarm*



Heat Sensor

*FHH10i Heat Alarm*





*FHB10 / 10i Smoke Alarm*



*FHH10i Heat Alarm*

Large Test Button

## *FHB10 – Product and Contact Details*

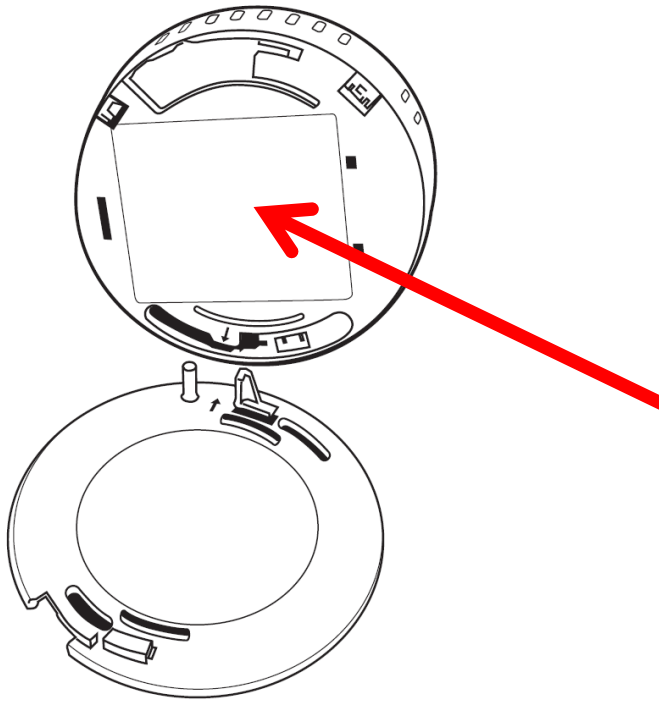





## *Light and Sounds*

**Power** = Brief Red flash every minute followed by a Single beep after 10 secs if the battery is weak



**Alarm** = Repeating Red flashing light twice every second + a series of 3 beeps every 4 seconds



**Alarm Silence** = Brief Red flash every 10 Seconds

**Test** = Repeating Red flashing light twice every second + a series of 3 beeps



**Fault** = Double Bleep every minute



**Test Button Jammed** = Single beep every 11 seconds



## *Alarm Silence*

*An alarm sound can be silenced (Hushed, Paused etc) by pressing the test button during an alarm*



- *Pressing the test button when the full alarm is sounding will silence the alarm for 10 minutes.*
- *For safety reasons it cannot be selected in advance.*

## *Silence Low Battery Warning*

*Low battery warnings generally start at night due to the most significant temperature changes that occur and can affect battery power. (not necessarily off load voltage)*



- *The FHB10 has a “Low Battery Silence” Feature.*
- *Pressing the test button when the Low Battery Warning system is activated will silence the warning for 10 hours.*
- *Have a good nights sleep and change the alarm the following day.*
- *For safety reasons it cannot be selected in advance.*



## ***FHB10 – Smoke Alarm Location***

***Correct location is imperative if nuisance alarms are to be avoided***

- ***Do NOT place in a draft.***
- ***Do NOT place near bathrooms and showers***
- ***Do NOT place in kitchens - use heat alarms there***
- ***KEEP AWAY from vents or extractor fans***
- ***Do NOT place directly above heaters, radiators or in front of air conditioning units***
- ***Do NOT place in insect infested areas (attics, garages etc) - use heat alarms there***
- ***KEEP 300mm AWAY from lights that generate heat. (Tungsten and low voltage bulbs)***
- ***KEEP AWAY from objects that could divert or prevent smoke from reaching them, ie beams and other ceiling features.***

***Remember: Heavy smoking in a poorly ventilated room produces  
DETECTABLE SMOKE and contaminates the alarm!!***



## *FHH10i Heat Alarm Location*

- *Remember, heat alarms need a fire to activate, flames WILL be present.*
- *Do NOT install on walls*
- *Do NOT use in escape routes*
- *ALWAYS interlink to smoke alarms*
- *Do NOT use in lounges, bedrooms and separate dining rooms where smoke alarms are best*
- *Avoid use in areas where children, the elderly and disabled are normally present*
- *Designed for kitchens, garages, cellars, attics where steam, vapours, dust, and cobwebs may cause nuisance alarms from smoke alarms*
- *Keep 300mm AWAY from lights and appliances that generate heat. (Tungsten and low voltage bulbs) (Sensor temperature range 54 – 65 deg C )*
- *KEEP AWAY from objects that could divert or prevent smoke and heat from reaching them, ie beams and other ceiling features.*
- *Keep away from extractor fans*



## *Fixing to Ceilings – Adaptor Plates*

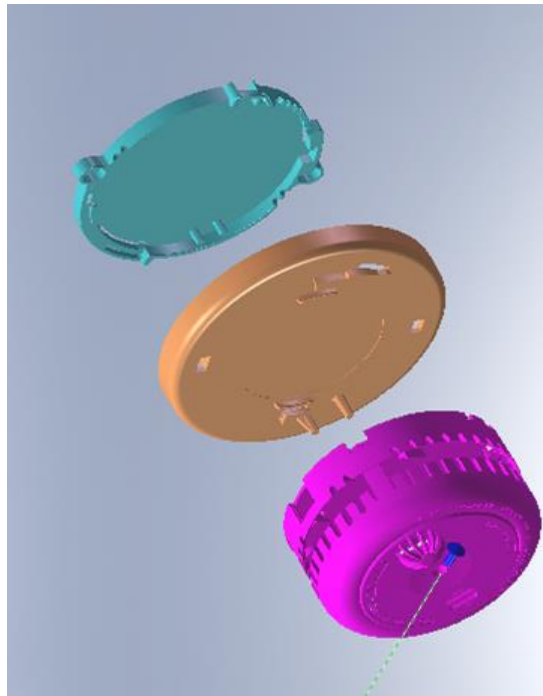

## *Fixing to Ceilings*

*Double-Sided  
Sticky Pad*

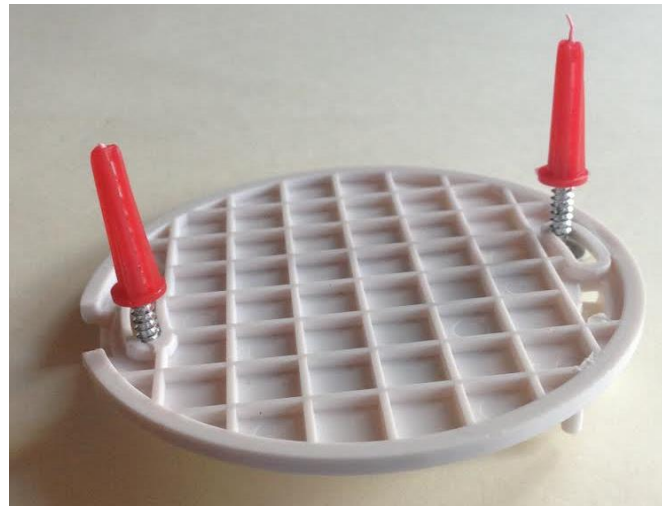

*Plugs and Screws*

*Adhesive*



## Assembly to Mounting Plate

*Bring  
together .....*

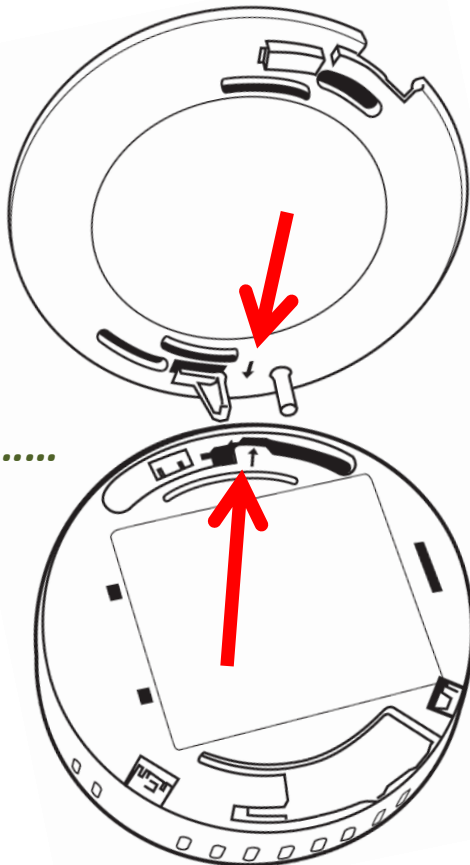

*..... and  
twist to lock*

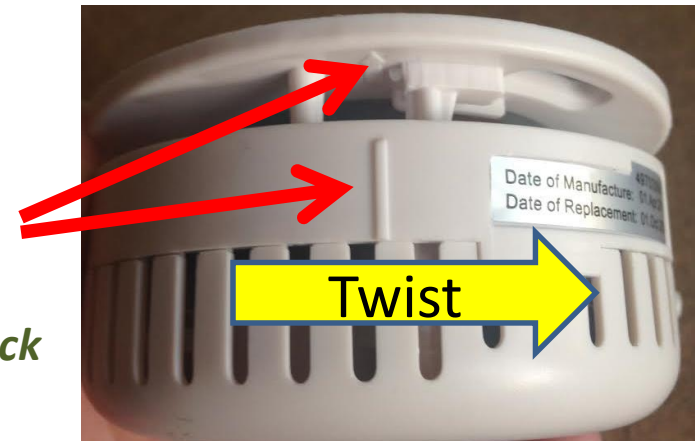

## *Removing from Ceilings – Security Tag*

Press here and twist alarm  
anti-clock to release

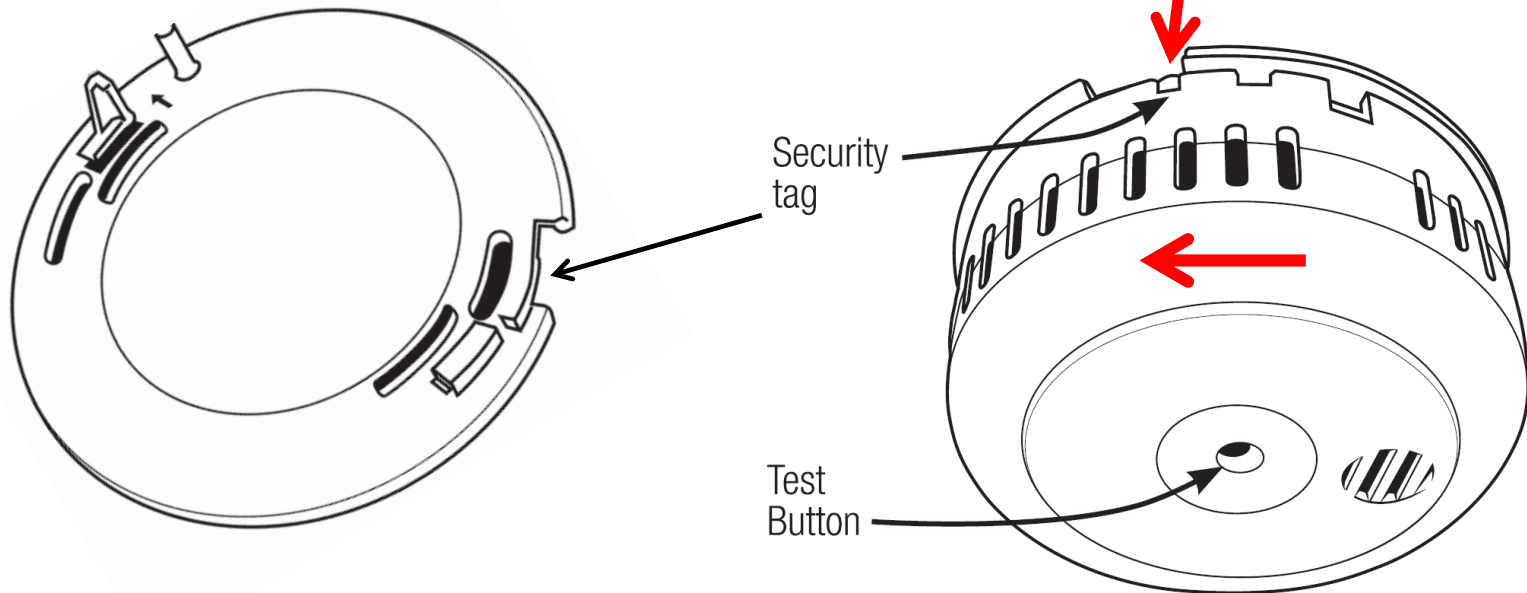

# *Fire Alarms – End User Maintenance*

- *REMEMBER - The overriding instruction is to ALWAYS follow the manufacturers guidance.*
- *Test the alarm once a week to ensure it is still operating*
  - *ONLY use the test button. Do NOT use smoke or flame. It is dangerous, will contaminate the alarm and give misleading results*
  - *If you must use canned smoke follow the manufacturers instructions.*
- *Vacuum the alarm to keep the vents clear of dust and insects*
- *Every six months clean the alarm with a damp cloth (do not use spray or chemical cleaners and polishes)*
- *In the event of a problem, contact our helpline on:-*

**0800 008 6568**



## Smoke and Heat Alarms- Trouble Shooting

- *Be sure which alarm has been the problem, upstairs, downstairs, heat or smoke.*
- *Are the alarms interlinked? - If so check which one has a fast flashing red light during an alarm – that's the one that has set the system off.*
- *Where is it installed? (refer to “Do nots..” list in manual and earlier). If it is in a poor location this might be causing nuisance alarms.*
- *What is the alarm doing? ie single or double beeps, nuisance alarms etc etc*
- *Was the occupier cooking, cleaning, dusting, using aerosol spays etc etc ? – if so these may have caused the alarm to sound due to contamination.*
- *Has there been any decorating or building work recently? – if so this may have contaminated the alarm and caused nuisance alarms*
- *Has there been outside fires, bonfires, chimneas, fire pits etc etc? – if so, the smoke may have got into the property via doors, windows and vents.*

# ***Firehawk Fire Alarms***

***Martin Ling. MSc, Cert Ed, MIFireE  
Technical Manager  
Fireblitz Extinguisher Ltd***

